

620 TERMINAL WAY • P. O. BOX 938 • COSTA MESA, CALIFORNIA 92627 • (714) 642-1163

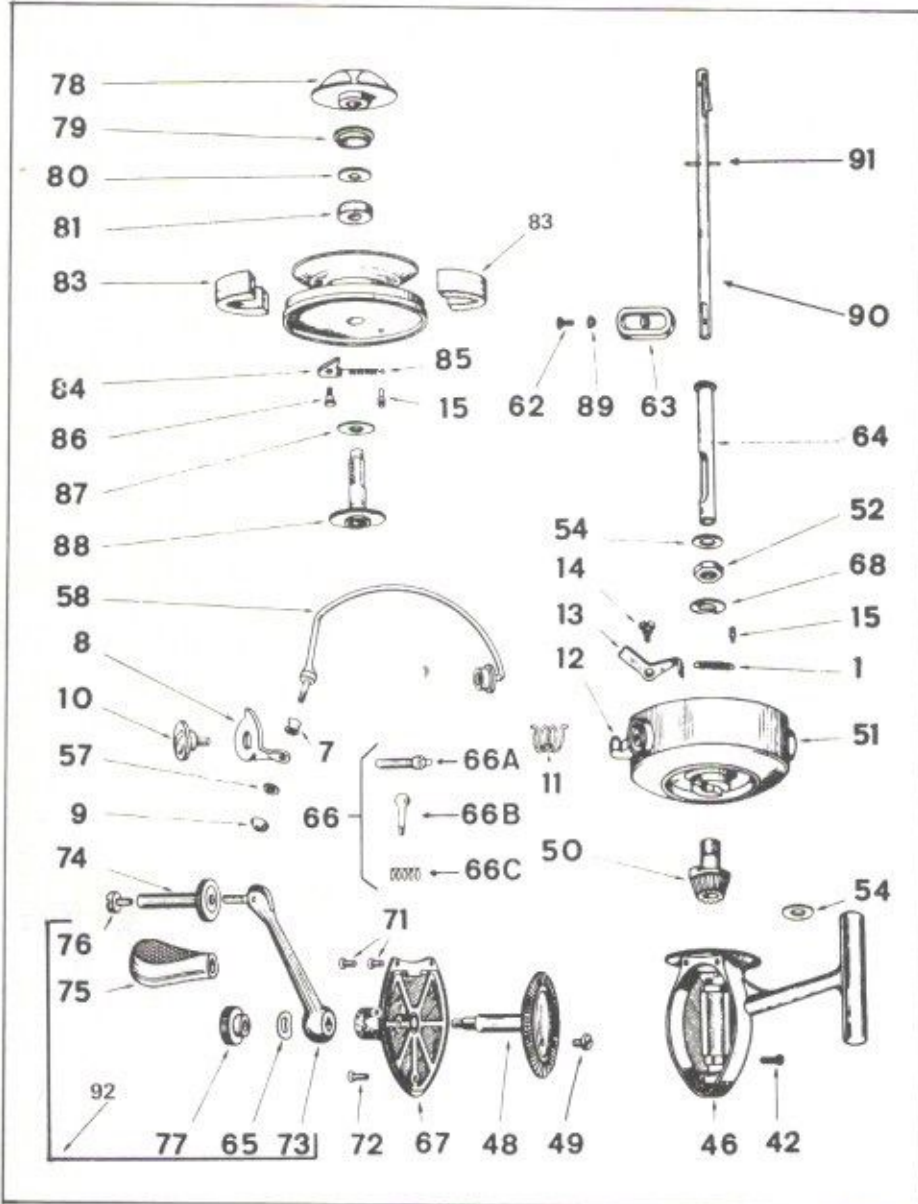

FIG NO.	PART NO.	DESCRIPTION	PRICE
7	100-018	Line guide	.60
8	102-517	Offset lever	.85
9	100-021	Hexagon nut	.30
10	100-047	Bearing screw for offset level	.55
11	100-060	Gear spring	.40
12	100-109	Rubber buffer	.25
13	102-516	Catch lever	.60
14	100-048	Lug screw for catch lever	.25
15	100-017	Stop pin	.25
16	100-056	Spring	.30
42	100-030	Screw for bearing bushing	.25
46	102-513	Case without cover	4.70
48	102-534	Bevel pinion with axle	3.90
49	102-521	Sliding screw for bevel pin	.30
50	102-535	Bevel pinion	2.60
51	102-515	Rotating head	4.45
52	100-024	Hexagon nut	.30
54	100-090	Washer for bearing bushing	.25
57	100-069	Lock washer for pickup arm	.30
58	100-816	Pickup arm with bushing	1.85
62	102-531	Screw for slide	.35
63	102-530	Slide	.75
64	102-533	Bearing bushing	2.45
65	102-546	Spring washer for crank nut	.30
66A	100-010	Bolt for anti reverse	.55
66B	100-011	Bolt for anti reverse	.45
66C	100-012	Spring for anti reverse	.25
67	102-550	Cover without anti reverse clutch	3.85
68	100-070	Spring washer for P/N 52	.25
71	100-026	Cover screw	.25
72	100-027	Cover screw, long	.25
73	102-552	Cover arm with swinging bolt	1.75
74	102-525	Knurled nut	1.05
75	102-527	Handle grip	.50
76	102-526	Grip screw	.30
77	102-553	Crank nut	.60
78	100-169	Brake nut	.65
79	102-518	Safety bushing for P/N 82	.35
80	100-104	Tongue washer	.30
81	102-554	Felt washer	.35
83	102-519	Cork ring halved	.40
84	100-014	Ratchet	.30
85	100-016	Ratchet spring for P/N 84	.30
86	100-015	Rivet	.25
87	100-087	Washer	.25
88	100-181	Brake spindle complete	1.50
89	102-532	Spring washer for P/N 63	.30
90	102-529	Axle, complete	2.00
91	100-041	Pin for P/N 90	.30
	240SK	Spool, complete	3.80
	240SK	Spool, shell	2.70